

# COUNTER TOP FILTER CARTRIDGE REPLACEMENT

M55

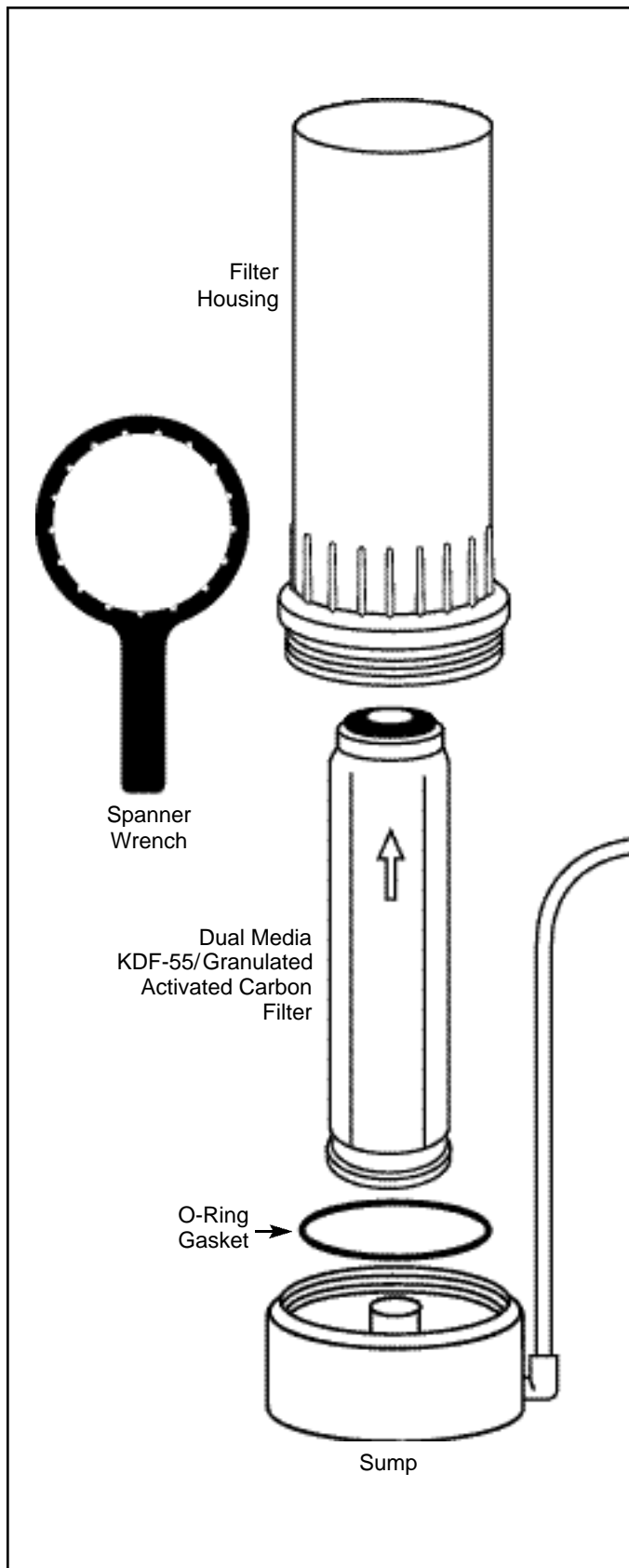

Basic procedure for replacement of Counter Top filter cartridge

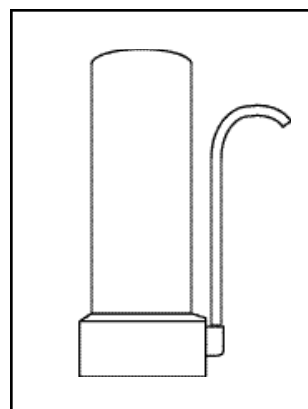

Counter Top Water Filter

- Make sure the filters are free flowing, if they become clogged you must replace them.
- Replace filters when needed, generally twice a year, depending on water use, quality, and conditions.
- Water condition and GPM determines need (hard water areas of the country may require more frequent replacements).

## TWT® SYSTEMS WITH PRESSURE GAUGES

1. Turn off water supply to Counter Top Filter.
2. Unscrew housing using spanner wrench (shipped with system).  
**NOTE:** When opening filter housing to change cartridge, it is common for O-Ring/Gasket to lift out of housing and stick to filter housing (remove carefully.)
3. Remove used cartridge and discard. Rinse out housing and about 1/3 full of water. Add about 2 to 3 table spoons of bleach and scrub thoroughly with brush or sponge. Rinse thoroughly.
4. Remove O-ring/Gasket from housing and wipe groove and O-ring/Gasket clean. Lubricate O-ring/Gasket with a coating of clean food grade silicone grease. Place O-ring /Gasket back in place and press O-ring down into groove with two fingers ( or place gasket on rim of sump).  
**NOTE:** This step is important to ensure proper seal. Make sure O-ring is seated level in the groove.  
**CAUTION:** If O-ring/Gasket appears damaged or crimped it should be replaced at this time, contact your distributor for replacement parts.
5. Insert the new cartridges into the sump.
6. Screw the housing onto the sump and hand tighten (**DO NOT OVER TIGHTEN**).
7. Turn on the water supply slowly to allow system to fill with water (check for leaks).

